

AIP SUPPLEMENT 012/2024

UNITED KINGDOM



UK Aeronautical Information Services
NATS Swanwick
Sopwith Way
Southampton SO31 7AY
aissupervisor@nats.co.uk
<http://www.nats.aero/ais>
07795-670187 (Content - EGKK)

Date Of Publication

8 Feb 2024

Notes

- (a) All times are UTC.
- (b) References are to the UK AIP.
- (c) Information, where applicable, should also be used to amend appropriate charts.



LONDON GATWICK AIRPORT (EGKK) - CONSTRUCTION OF NEW RAPID EXIT TAXIWAY ECHO ROMEO FOR RUNWAY 26L AND NEW TAXIWAY ECHO, CLOSURE OF RUNWAY 26L RET ECHO - REPLACES SUP 078/2023

1 Introduction

Work is in progress and continues into **February 2024** to construct a new Rapid Exit Taxiway (RET) for Runway 26L. The new RET will be designated Echo Romeo.

The disused Echo RET, East of Echo Romeo RET, has been permanently withdrawn from use.

An additional section of taxiway to be designated Taxiway Echo is also being constructed between Runway 08L/26R and Taxiway Juliet. It will not open until **2025 (January to March)**.

All areas are shown on the charts below.

2 Programme

Works are planned to continue **each Monday to Friday until 21 February 2024**. Day and night work will be required.

Echo RET was permanently withdrawn from use on **27 November 2023**.

The new Echo Romeo RET is expected to become operational at **0500 on 21 February 2024**. Exact timings will be confirmed in Airport Notices, NOTAMs and ATIS messages as appropriate.

The new section of taxiway - Taxiway Echo, is expected to become operational in **2025 (January to March)**.

3 Operational Implications

There are three works areas as described below and as shown on the chart. Only one site will be active at any time. Dates, timings and operational implications for each site will vary throughout the project and details will be contained in NOTAMs.

1. Runway 08R/26L WIP Area:

- Work will be undertaken at night, Monday to Friday nights;
- Runway 08R/26L will be closed and Runway 08L/26R will be in operation;
- Outside of working periods Runway 08R/26L will be available for use as published in the UK AIP.

2. Runway 08L/26R WIP Area:

- Work will be undertaken during day and night periods, Monday to Friday;
- Runway 08L/26R will be closed between Taxiway Tango and Foxtrot Romeo RET;
- Foxtrot Romeo RET will remain available unless advised by NOTAM, however the route from Foxtrot Romeo RET eastbound onto Runway 08L/26R will not be available;
- During working periods, Runway 08L/26R can be made available within four hours;
- Outside of working periods Runway 08L/26R will be available for use as published in the UK AIP.

3. Taxiway Juliet WIP Area:

- Work will be undertaken during day and night periods, Monday to Friday;
- Taxiway Juliet will be closed between its junctions with Taxiways Uniform and Golf;
- Outside of working periods Taxiway Juliet will be available for use as published in the UK AIP.

4 General

4.1 Worksite Markings

The worksites will be marked and lit with red lights. Pilots should note there will be increased vehicular traffic with flashing obstruction lighting during working periods. Vehicles up to 5 M AGL are permitted adjacent to the Runway 08R/26L strip, details will be confirmed in a NOTAM.

4.2 Echo Romeo RET and Taxiway Echo Construction

Whilst the new RET and taxiway are under construction they will be marked with red lights to denote they are unfit for the movement of aircraft.

4.3 Site Access

Works access to the sites will be under GAL Airfield Operations Leader Escort.

4.4 Further Information

Further information will be contained in NOTAMs, Airport Notices and messages on ATIS as appropriate. The UK AIP will be amended in due course.

5 Completion of Works

On completion of the works the new RET Echo Romeo and new Taxiway Echo will become operational as follows:

Echo Romeo RET will have all relevant markings, signage and lighting including Taxiway Unavailable Bars (TUBs). The lead-on and lead-off configuration replicates existing RETs and will include Rapid Exit Taxiway Indicator Lights (RETILS). The distance from threshold will be 1483 M and the design exit speed 50 KT.

Taxiway Echo will be fully constructed, however it will remain closed with the stop bar illuminated H24 until it becomes operational. Taxiway Echo is planned to open in **2025 (January to March)** with appropriate markings, signage and lighting.

The disused Echo RET will be marked with yellow crosses and all taxiway markings, signage and taxiway lighting will be removed. The Taxiway Unavailable Bars (TUBs) will be illuminated H24. A 20 M strip of asphalt will be removed adjacent to the runway shoulder and will be replaced with grass. Once the grass area has become established the TUBS will be decommissioned.

Specific timings will be confirmed by NOTAM.

6 Enquiries

For any enquiries regarding these works contact:

Office Hours:	Aerodrome Project Integration Lead	07795-670187
Out Of Office Hours:	Aerodrome Operations Manager	07803-120115

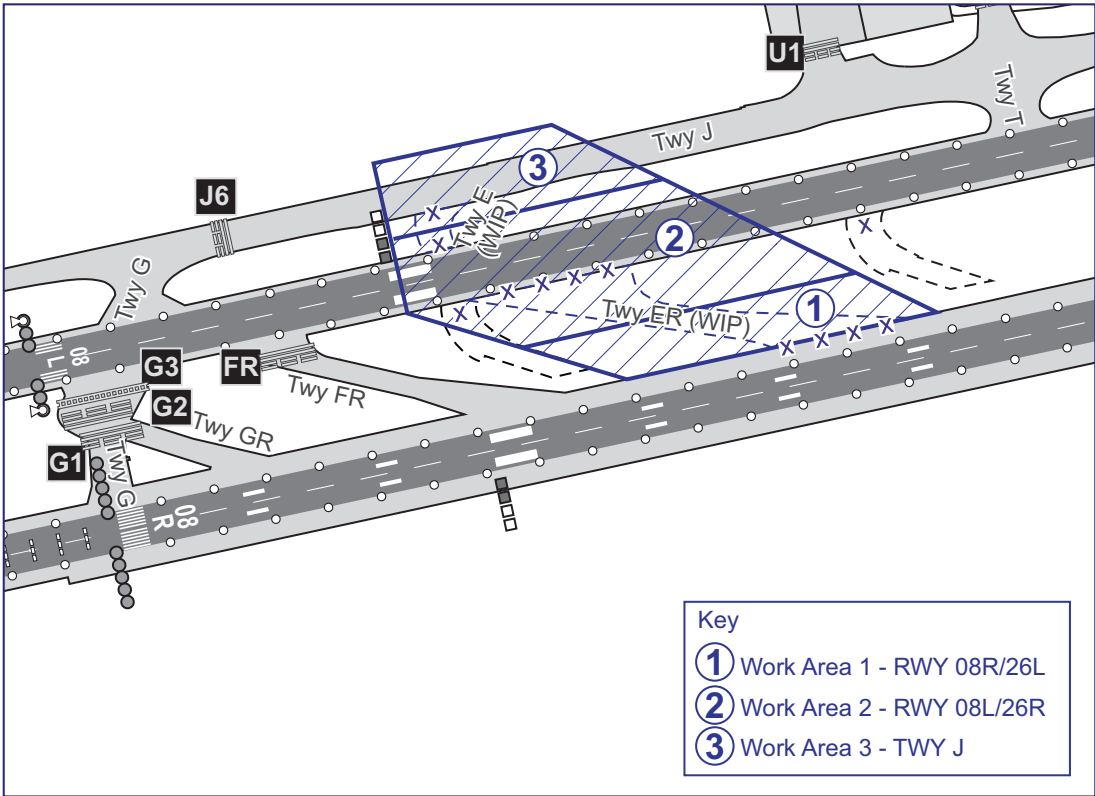

2024_001_CR08040_1_EGKK RET ER_GRAPHIC DRAWN 04JAN24

Layout After Opening of ER RET

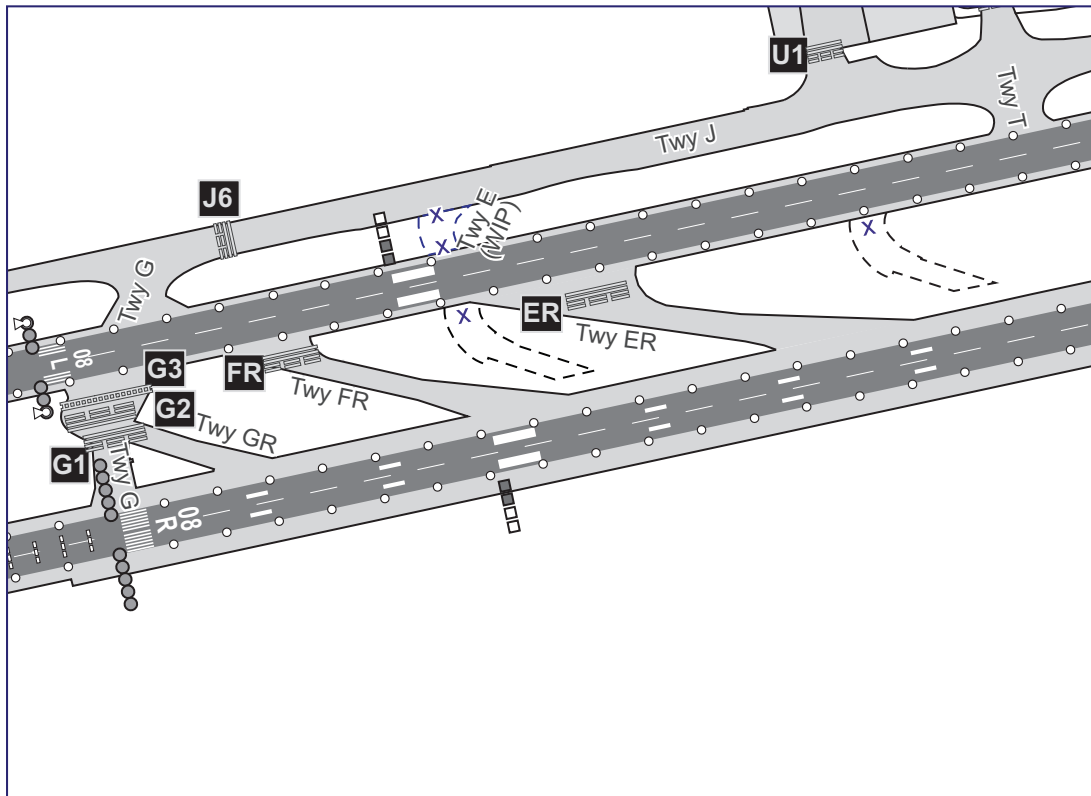

2024_001_CR08040_2_EGKK RET ER_GRAPHIC DRAWN 04JAN24