

MAGNETIC VARIATION 0°E (2022)

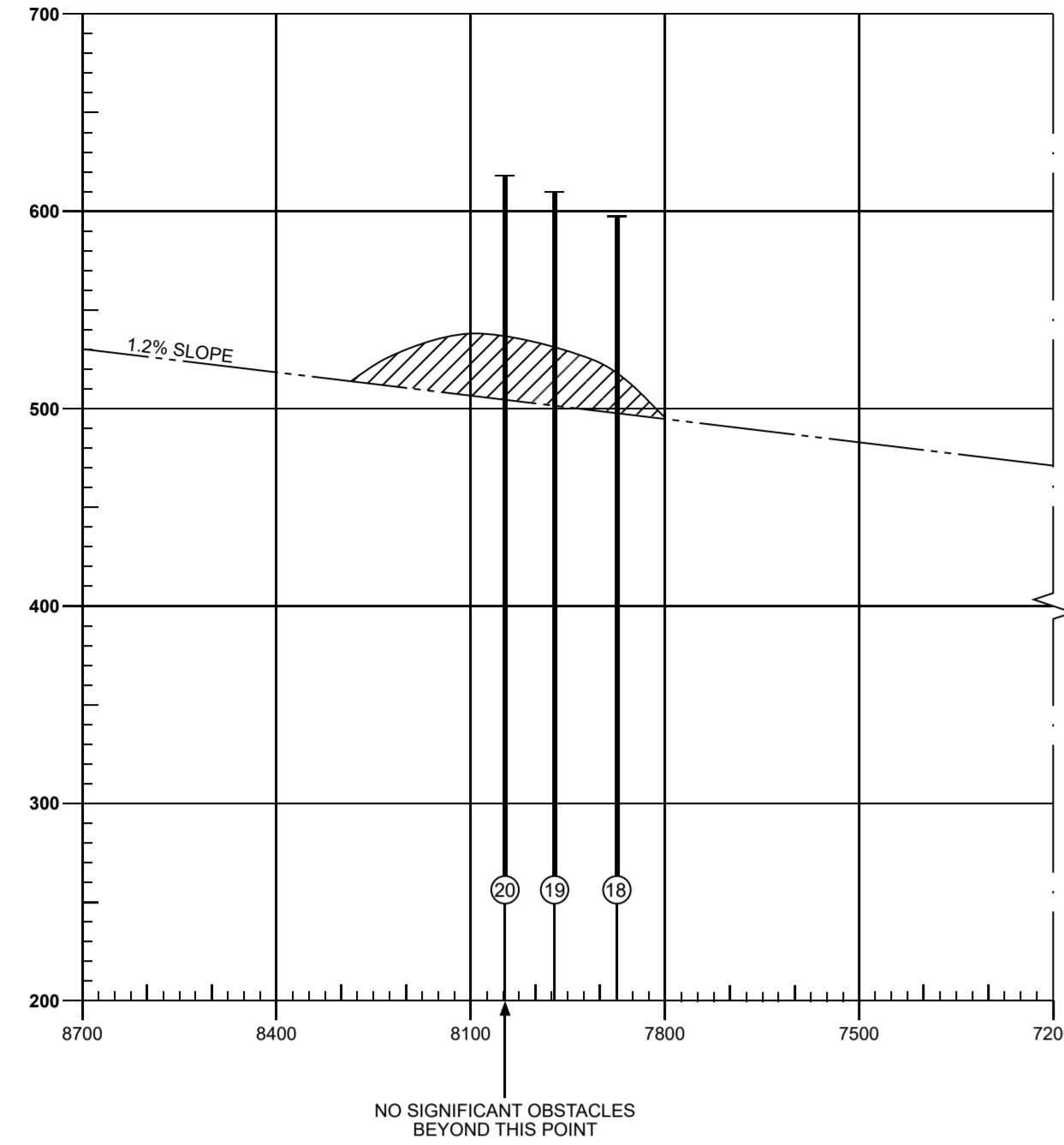

NO SIGNIFICANT OBSTACLES BEYOND THIS POINT

RUNWAY 01-19

DECLARED DISTANCES

RWY 01		RWY 19
1442	TAKE-OFF RUN AVAILABLE	1383
1442	ACCELERATE-STOP DISTANCE AVAILABLE	1383
1592	TAKE-OFF DISTANCE AVAILABLE	1558
1319	LANDING DISTANCE AVAILABLE	1319

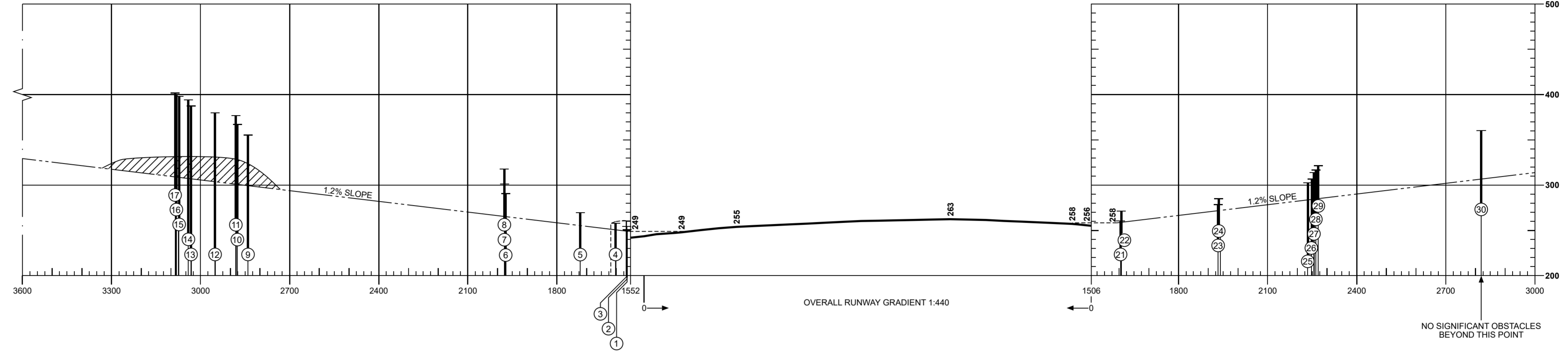

OVERALL RUNWAY GRADIENT 1:440

NO SIGNIFICANT OBSTACLES BEYOND THIS POINT

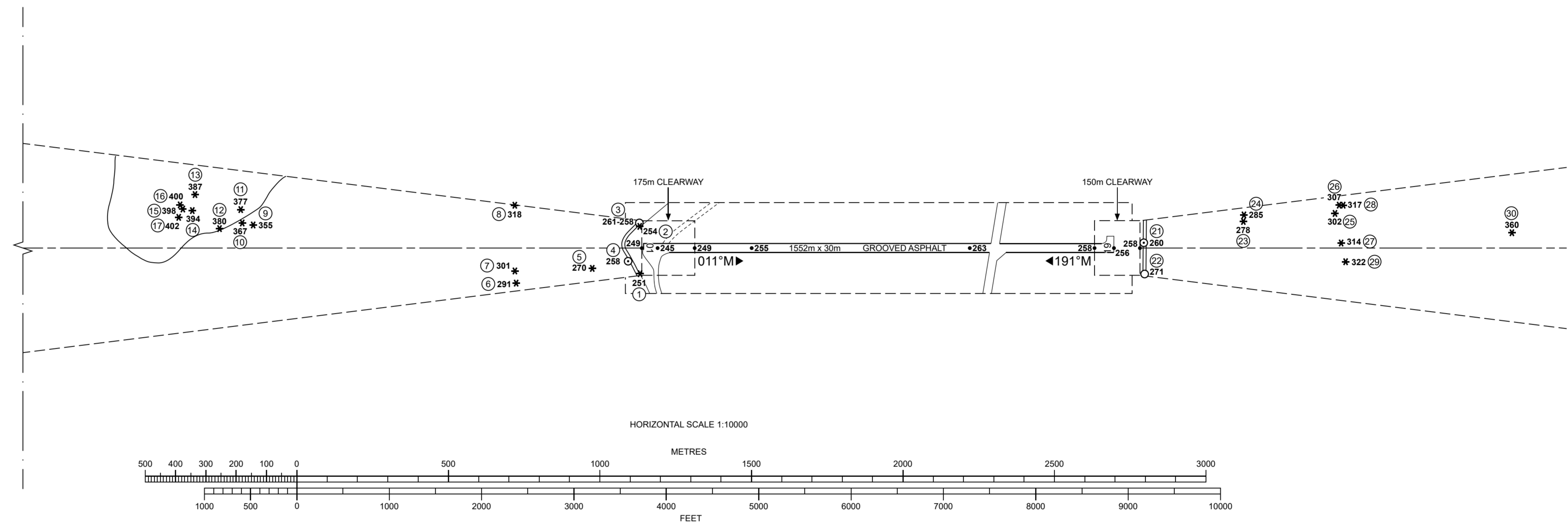
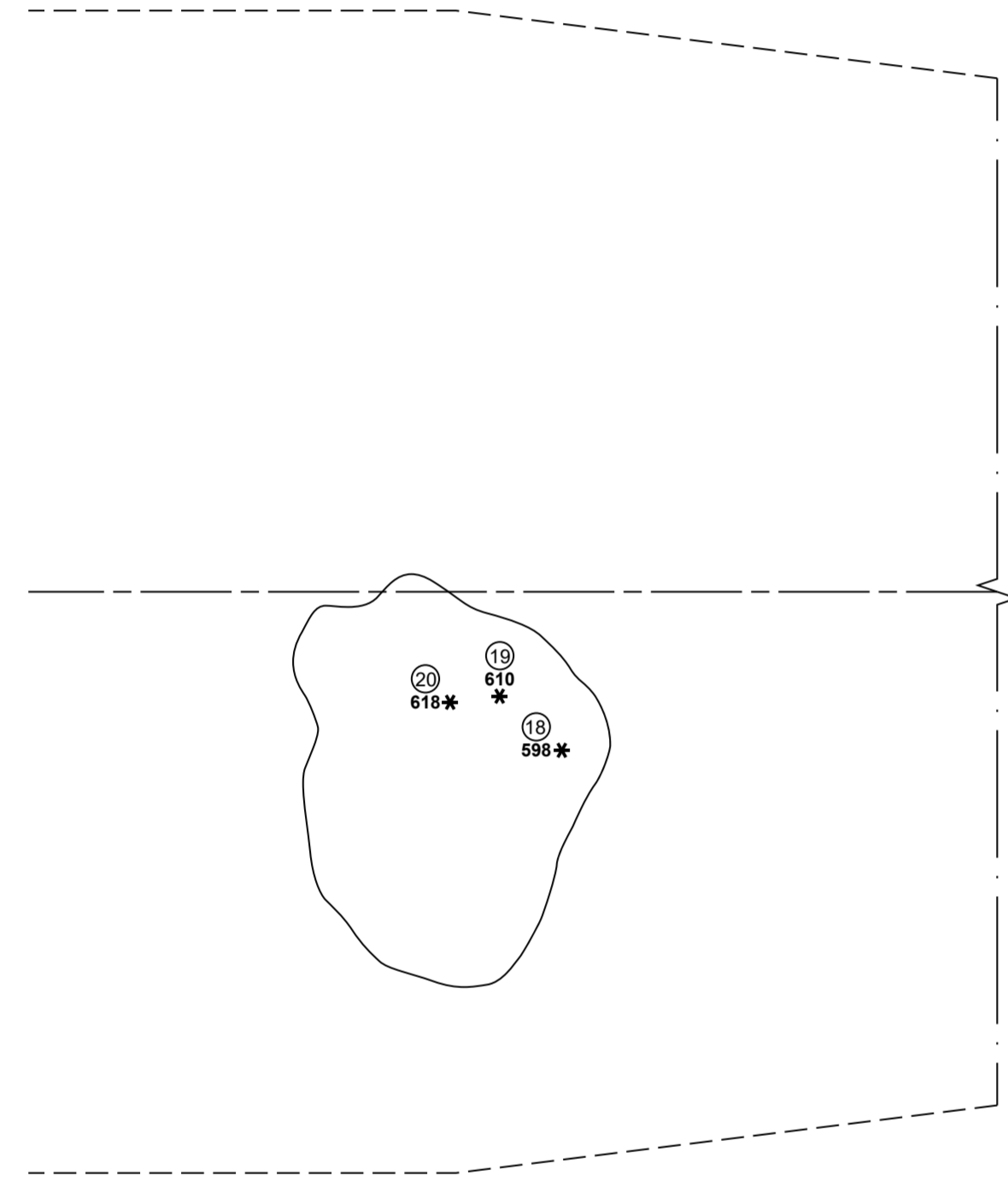
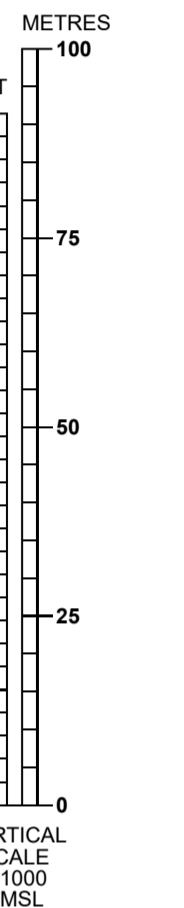

HORIZONTAL SCALE 1:10000

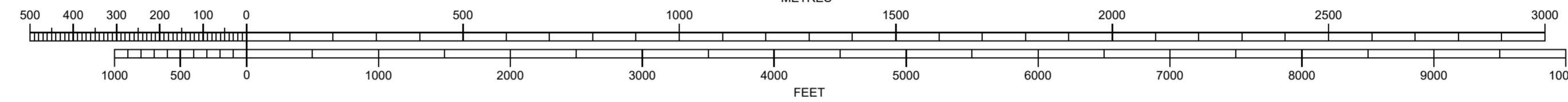

Obstacle Number	Survey Number	Description	Latitude	Longitude	Altitude (M)	Altitude (ft)
1	10411	HEDGE	514945.86N	0011915.62W	76.53	251.08
2	3073	HEDGEROW	514946.77N	0011923.70W	77.15	253.12
3	9628	ROAD+4.8	514946.78N	0011924.25W	79.43	260.60
2a	11498	HEDGE	514946.49N	0011923.40W	77.55	254.42
3a	9627	ROAD+4.8	514945.53N	0011916.08W	79.51	260.86
3b	9609	ROAD+4.8	514946.27N	0011923.69W	79.21	259.88
3c	9604	ROAD+4.8	514945.31N	0011917.25W	79.38	260.43
3d	9605	ROAD+4.8	514944.97N	0011918.94W	79.17	259.74
4	3127	ROADSIGN	514944.86N	0011918.11W	78.54	257.68
3e	9608	ROAD+4.8	514945.35N	0011922.67W	78.85	258.69
3f	9606	ROAD+4.8	514944.70N	0011920.10W	78.71	258.23
3g	9607	ROAD+4.8	514944.72N	0011921.42W	78.52	257.61
5	11648	TREE	514940.96N	0011918.06W	82.20	269.67
6	11383	TREE	514932.68N	0011917.98W	88.61	290.70
7	11634	TREE	514932.79N	0011920.08W	91.85	301.36
8	11438	TREE	514934.08N	0011931.21W	96.81	317.62
9	11432	TREE	514906.24N	0011936.22W	108.34	355.45
10	3152	TREE	514905.14N	0011936.91W	111.90	367.13
11	11144	TREE	514905.24N	0011939.23W	114.56	375.84
11a	11637	TREE	514905.20N	0011939.63W	114.82	376.72
12	11139	TREE	514902.64N	0011936.68W	115.78	379.87
13	11146	TREE	514900.74N	0011943.23W	117.21	384.54
13a	11147	TREE	514900.51N	0011943.67W	117.99	387.12
14	11635	TREE	514900.14N	0011940.60W	120.15	394.19
15	11411	TREE	514859.18N	0011941.17W	121.36	398.15
16	11636	TREE	514858.97N	0011941.95W	121.80	399.59
17	11632	TREE	514858.58N	0011939.89W	122.44	401.70
18	5886	TREE	514624.30N	0012008.37W	182.15	597.61
19	5890	TREE	514621.74N	0012013.59W	185.82	609.65
20	5891	TREE	514619.25N	0012013.85W	188.40	618.11

Obstacle Number	Survey Number	Description	Latitude	Longitude	Altitude (M)	Altitude (ft)
21	10243	CRASHGATE	515039.31N	0011904.77W	79.35	260.33
22	9504	ROAD+4.8	515038.78N	0011859.45W	82.67	271.23
23	11528	TREE	515050.18N	0011905.20W	84.86	278.40
24	11524	TREE	515050.37N	0011906.28W	86.83	284.87
25	11533	TREE	515059.95N	0011903.63W	92.16	302.37
26	11530	TREE	515100.55N	0011904.91W	93.52	306.84
27	11720	TREE	515100.01N	0011858.42W	95.68	313.92
28	11303	TREE	515100.98N	0011904.77W	96.57	316.82
29	11554	TREE	515100.11N	0011855.11W	98.03	321.63
30	11724	TREE	515118.13N	0011854.71W	109.80	360.23

LEGEND		
	PLAN	PROFILE
IDENTIFICATION NUMBER	Ⓢ	Ⓢ
HEIGHT AMSL	318	Ⓢ
POLE, TOWER, SPIRE, ANTENNA, ETC.	⊙	⊙
TREE, HEDGE, BUSH, ETC.	*	*
MOBILE OBSTACLE	⊠	⊠
TERRAIN PENETRATING OBSTACLE PLANE	⬭	⬭

ORDER OF ACCURACY: Horizontal 3m; Vertical 1ft
CHANGE: NEW SURVEY
 Aerodrome information current : APRIL 2022
 Based on survey dated : JUNE 2021
 Chart effective date : 12 APRIL 2022

