

MAGNETIC VARIATION 1°W (2022)

**RUNWAY 08-26**

DECLARED DISTANCES			
RWY 08		RWY 26	
2036	TAKE-OFF RUN AVAILABLE	2076	
2036	ACCELERATE-STOP DISTANCE AVAILABLE	2076	
2252	TAKE-OFF DISTANCE AVAILABLE	2657	
2036	LANDING DISTANCE AVAILABLE	2036	

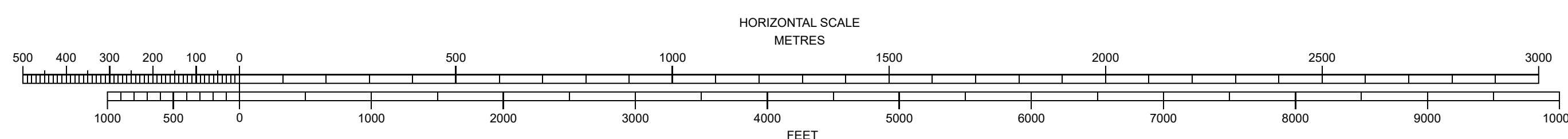
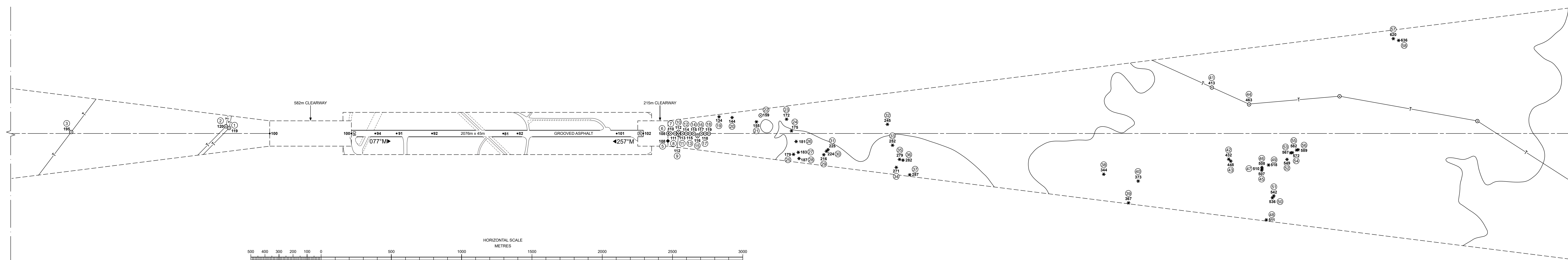
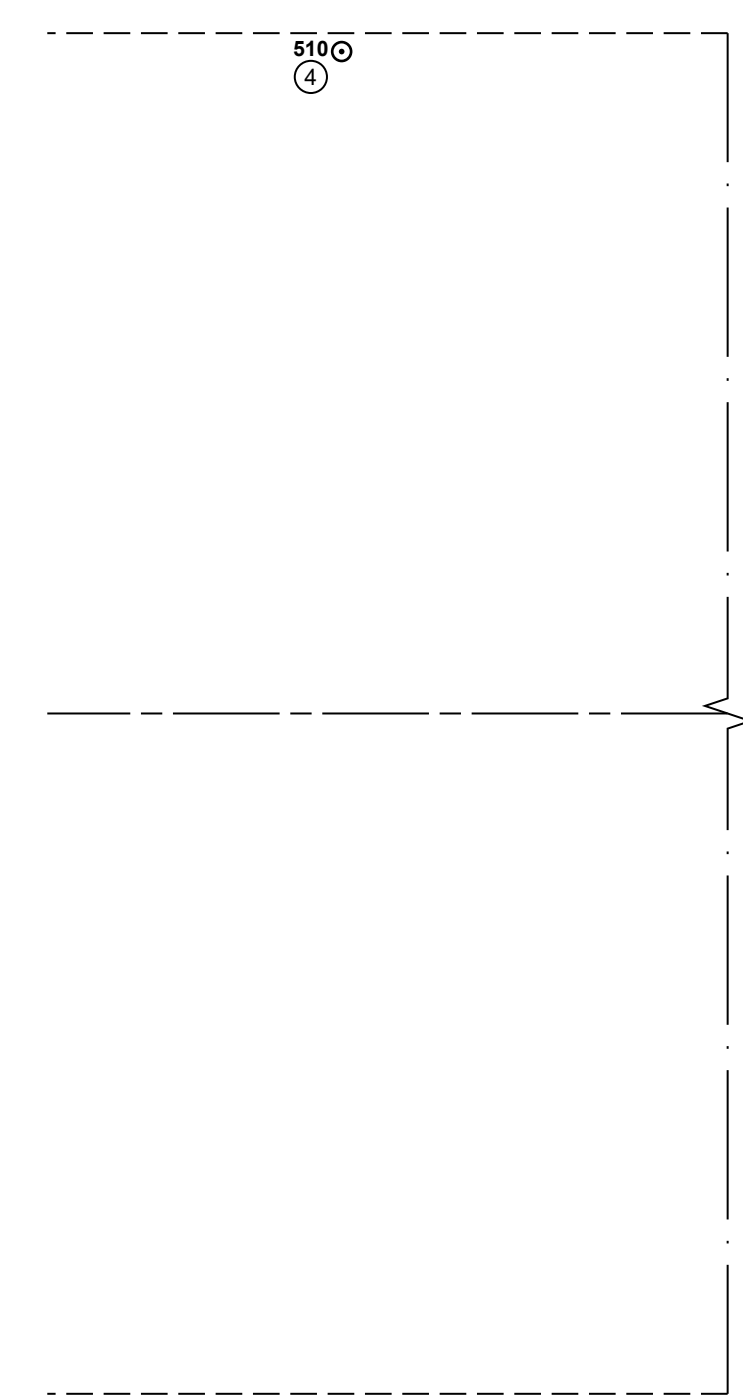
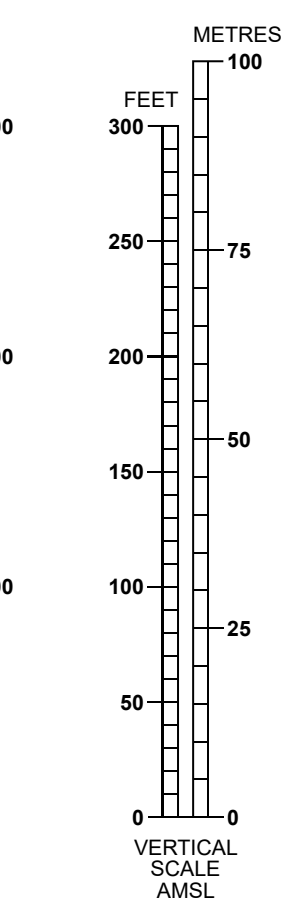
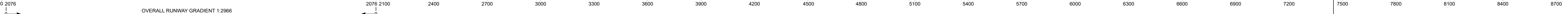
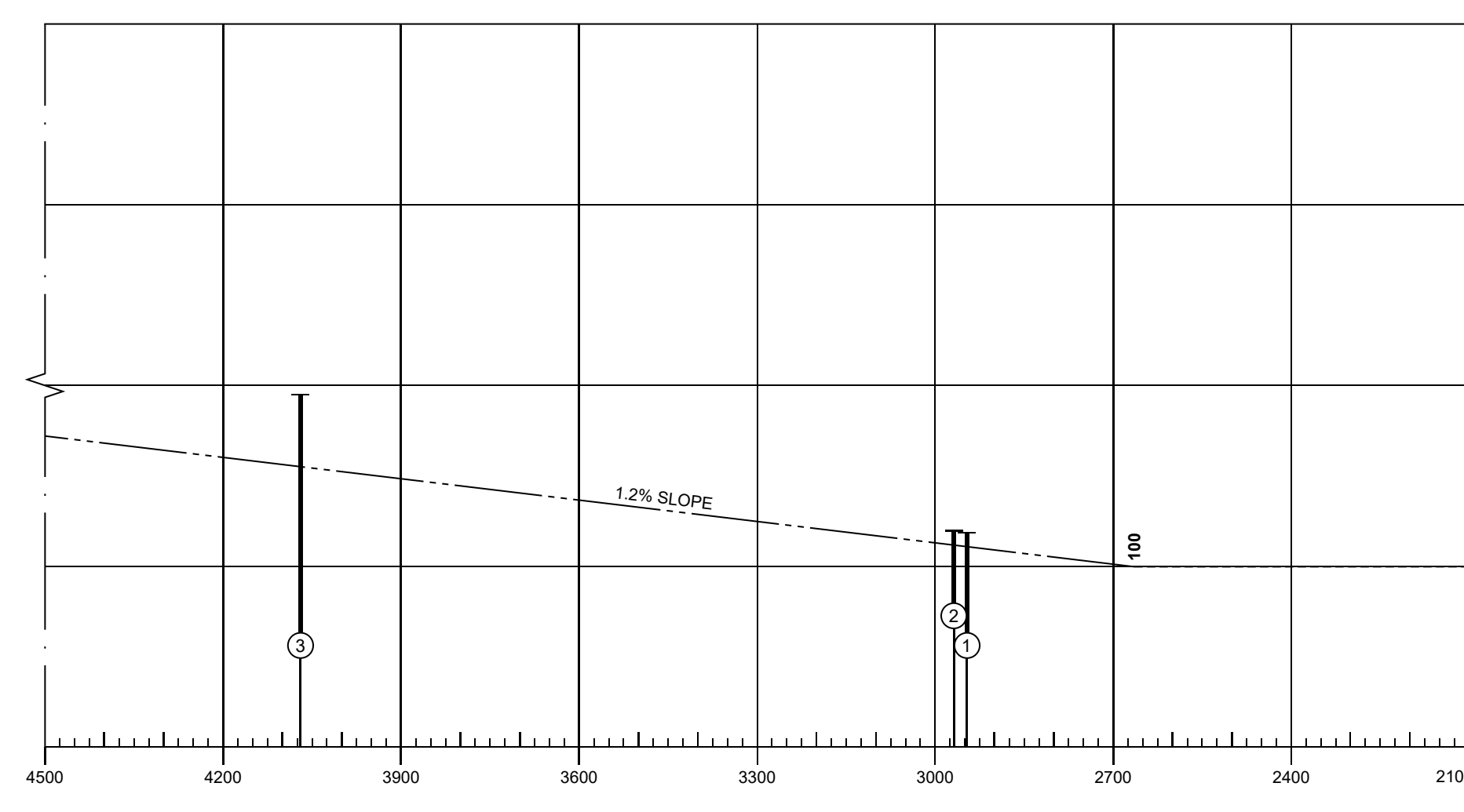
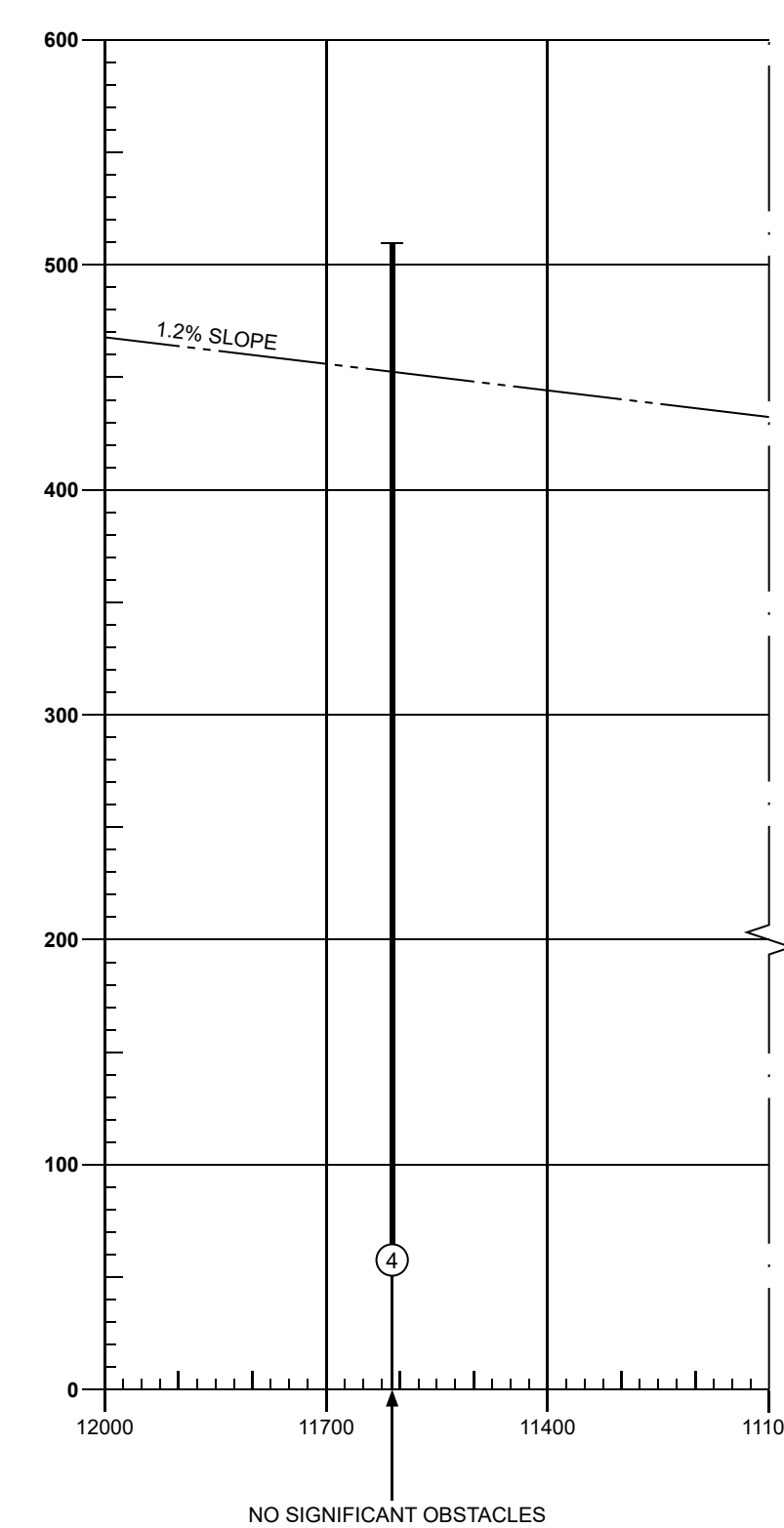

Obstacle Number	Survey Number	Description	Latitude	Longitude	Altitude (M)	Altitude (ft)
1	10062	PYLON	504349.91N	0032624.37W	36.17	118.67
2	10061	PYLON	504350.11N	0032625.62W	36.48	119.69
3	10541	PYLON	504340.30N	0032719.62W	59.47	195.11
4	10085	MAST	504308.93N	0033343.46W	155.34	509.65

Obstacle Number	Survey Number	Description	Latitude	Longitude	Altitude (M)	Altitude (ft)
5	14265	BUILDING	504411.2347N	0032348.6813W	32.98	108.20
6	14310	FFM 26	504412.91N	0032349.27W	33.01	108.30
7	13567	APPROACH LIGHT	504413.04N	0032348.44W	33.56	110.11
8	13568	APPROACH LIGHT	504413.29N	0032346.82W	33.85	111.06
9	13577	APPROACH LIGHT	504413.19N	0032345.48W	34.13	111.98
10	13570	APPROACH LIGHT	504413.86N	0032345.74W	34.14	112.01
10a	13573	APPROACH LIGHT	504413.61N	0032345.64W	34.15	112.04
11	13580	APPROACH LIGHT	504413.72N	0032344.26W	34.40	112.86
12	13582	APPROACH LIGHT	504413.88N	0032342.90W	34.64	113.65
13	13583	APPROACH LIGHT	504414.09N	0032341.57W	34.91	114.53
14	13584	APPROACH LIGHT	504414.30N	0032340.23W	35.16	115.35
15	13587	APPROACH LIGHT	504413.96N	0032338.69W	35.43	116.24
16	13588	APPROACH LIGHT	504414.72N	0032337.56W	35.70	117.13
17	13589	APPROACH LIGHT	504414.93N	0032336.22W	36.00	118.11
18	13590	APPROACH LIGHT	504415.13N	0032334.89W	36.27	119.00
19	14000	TREE	504419.44N	0032332.78W	40.62	133.92
20	14003	TREE	504419.99N	0032328.11W	43.96	144.23
21	14005	TREE	504420.38N	0032319.17W	47.10	154.53
22	11240	TELEGRAPH POLE	504422.05N	0032318.27W	48.42	158.86
23	14119	TREE	504422.63N	0032308.78W	52.42	171.98
24	13777	TREE	504420.31N	0032306.03W	53.27	174.77
25	14225	TREE	504415.1834N	0032303.2699W	54.48	178.74
26	13399	TREE	504418.20N	0032303.47W	55.16	180.97
27	13410	TREE	504415.89N	0032301.79W	55.73	182.84
28	13415	TREE	504414.56N	0032300.99W	56.73	186.12
28a	13423	TREE	504414.31N	0032300.64W	56.97	186.91
29	13791	TREE	504416.76N	0032252.58W	65.83	215.98
30	13406	TREE	504417.69N	0032251.94W	68.19	223.72
31	13794	TREE	504418.13N	0032251.59W	68.72	225.46
32	14234	TREE	504427.068N	0032232.7954W	74.63	244.85

Obstacle Number	Survey Number	Description	Latitude	Longitude	Altitude (M)	Altitude (ft)
33	13807	TREE	504422.67N	0032229.19W	76.76	251.84
34	13412	TREE	504417.94N	0032225.95W	82.71	271.36
35	13668	TREE	504419.91N	0032225.50W	85.04	279.00
36	13737	TREE	504419.92N	0032224.21W	85.89	281.79
37	13743	TREE	504417.03N	0032220.57W	87.52	287.14
38	10975	TREE	504427.85N	0032112.28W	104.78	343.77
39	12720	TREE	504422.83N	0032101.06W	112.01	367.49
40	10978	TREE	504428.21N	0032059.56W	113.61	372.74
41	10049	PYLON	504453.16N	0032041.69W	125.87	412.96
42	12639	TREE	504438.10N	0032029.55W	131.55	431.59
43	12640	TREE	504437.76N	0032028.65W	136.45	447.67
44	10050	PYLON	504451.44N	0032027.12W	141.12	462.99
45	12654	TREE	504437.44N	0032016.95W	154.41	506.59
46	12656	TREE	504438.10N	0032017.14W	154.90	508.20
47	12655	TREE	504437.77N	0032016.98W	155.37	509.74
48	11423	TREE	504426.62N	0032011.05W	155.86	511.35
49	12660	TREE	504438.99N	0032015.00W	157.74	517.52
50	12651	TREE	504431.87N	0032010.82W	163.31	535.79
51	12652	TREE	504432.39N	0032010.47W	164.02	538.12
51a	12653	TREE	504432.75N	0032010.30W	165.17	541.90
52	13435	TREE	504441.25N	0032008.98W	167.44	549.34
53	13436	TREE	504442.93N	0032008.26W	172.95	567.42
54	12676	TREE	504443.06N	0032007.67W	174.39	572.15
55	12678	TREE	504443.87N	0032006.44W	177.53	582.45
56	13437	TREE	504444.02N	0032005.89W	179.42	588.65
56a	12059	TREE	504444.21N	0032005.72W	179.65	589.40
57	12531	TREE	504514.06N	0031941.99W	188.95	619.91
58	10950	TREE	504513.96N	0031939.97W	192.08	630.18
58a	10134	TREE	504514.22N	0031939.82W	193.81	635.86

LEGEND		
	PLAN	PROFILE
IDENTIFICATION NUMBER	①	—
HEIGHT AMSL	111	—
POLE, TOWER, SPIRE, ANTENNA, ETC.	⊙	—
TREE	*	—
BUILDING	◆	—
TERRAIN PENETRATING OBSTACLE PLANE	○	—

**NATS**  
Civil Aviation Authority

ORDER OF ACCURACY: Horizontal 3m; Vertical 1ft  
CHANGE: NEW SURVEY.  
Aerodrome information current: MAY 2021  
Based on survey dated: FEBRUARY 2021  
Chart effective date: 4 JUNE 2021